



Empty enclosures
M2PA

Product designation

Product type designation

Electrical features

Maximum operating current (=440V) A 32

Components

Contactor standard supplied BF25A, BF26A, BF32A

Thermal relay to purchase separately RF38

Mechanical features

Weight g 715

Ambient conditions

Operating temperature

min	°C	-25
max	°C	+60

Storage temperature

min	°C	-40
max	°C	+70

Resistance & Protection

Frontal IP degree IP65

Dimensions

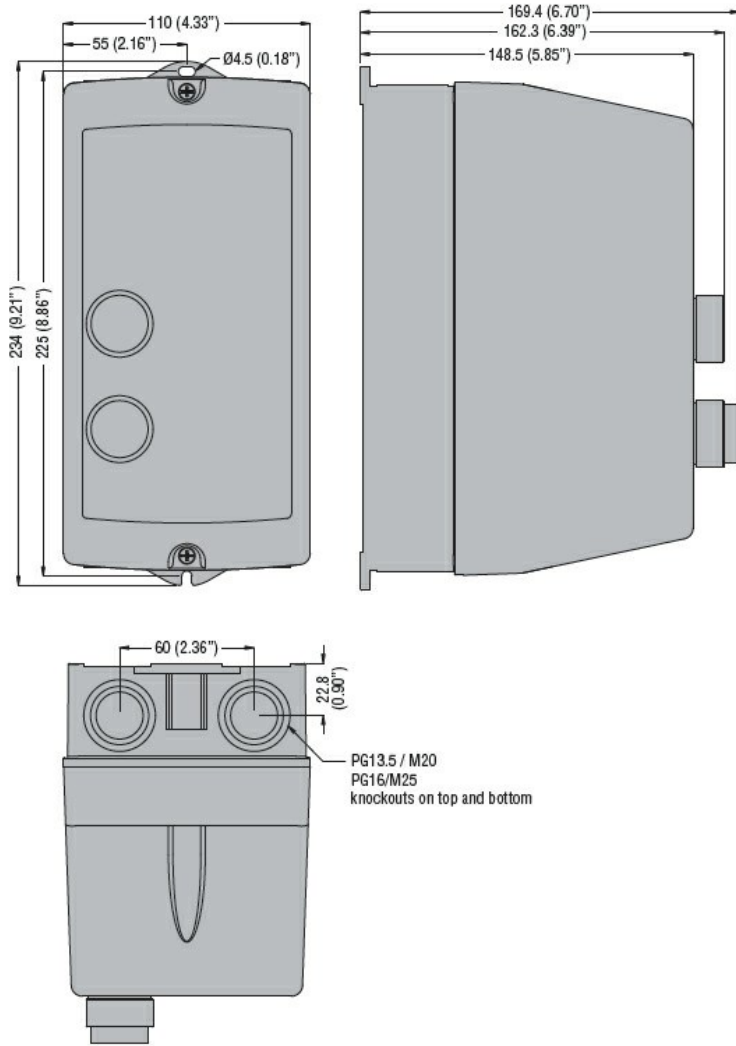

Wiring diagrams

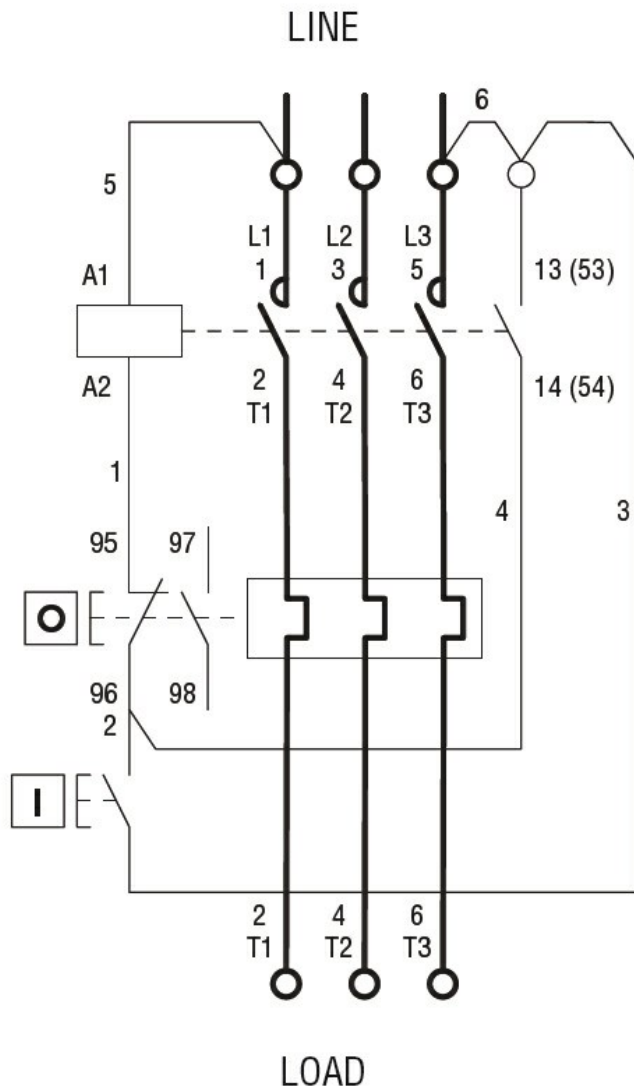

I = Start; O = Stop/Reset

Certifications and compliance

Compliance

CSA C22.2 n° 14
 IEC/EN 60947-1
 IEC/EN 60947-4-1
 UL508

Certificates

cULus

ETIM classification

ETIM 8.0

EC000200 -
 Enclosure for
 control circuit
 devices